

E4-WM5-Y164A00 MOUNTING INSTRUCTION



1. BILSTEIN shock absorber with original spring
2. BILSTEIN shock absorber with BILSTEIN spring
3. Original shock absorber with BILSTEIN spring

Remove

Place vehicle on a chassis hoist,
lift it and remove wheels.



The lower control arm must be supported by suitable means!

Remove bottom mount.

If necessary release brake hose/ brake hose holder/
stabilizer/ ABS- hose and/ or swing- support at strut.

Cable clip at the bracket must be removed
non-destructive and reused for install Bilstein strut.

At support suspension arm, screw on top,
inside must be released a little.

Remove top fixing nuts from support bearing.
Do not remove centre nut at this time!

Remove complete strut and
clamp it in an appropriate strut vice.

Using a suitable spring compressor, compress
suspension spring until tension on support
bearing is released.

Fit original/ BILSTEIN mounting parts on strut in
reverse sequence to removal, except for dust cover
and bump stop, since BILSTEIN- strut has built
in bump stop. If there is no dust cover delivered
by BILSTEIN, the original one is to be reused.
Please refer to diagram to identify which parts will
be replaced with BILSTEIN- supplied components.

Install

Assemble BILSTEIN and/ or original mounting
parts, as well as the new BILSTEIN spring
on the BILSTEIN strut in reverse sequence
of removal.



Before releasing the spring, care is to be taken to ensure that the spring rest in the cut outs of top and bottom spring plate!

The correct mounting position of the suspension
springs can be determined by the printing on
the springs; install them with the print upright.

Fit assembled BILSTEIN strut to
the vehicle in reverse sequence of removal.

E4-WM5-Y164A00 MOUNTING INSTRUCTION



- list of torques

| | M8 | M 10 | M 12 | M 14 | M 16 | Thread |
|--|----|------|------|------|------|-----------------|
| | 13 | 25 | 45 | 72 | 110 | Torque Nm |
| | 10 | 19 | 34 | 54 | 83 | Torque ft lb |

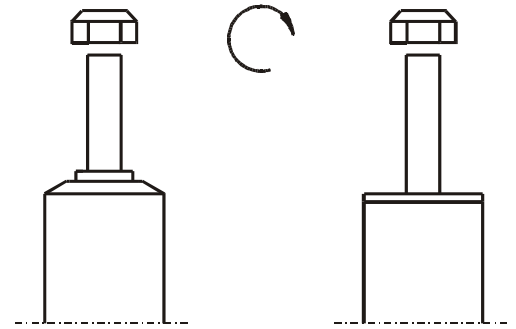

Do not use an impact tool to loosen or tighten fasteners due to possible Damage to the product. Self- locking nuts must only be used once!

All rubber- mounted strut/ damper attachments must not be fully tightened until AFTER the suspension system is loaded (wheels on the ground). Other mounting fasteners (for example brackets) must be securely tightened BEFORE load is placed on the suspension system.

ALL DIAGRAMS ARE GENERALIZED AND NOT TO SCALE! BRACKETS, ETC. SPECIFIC TO STRUT ARE NOT SHOWN!

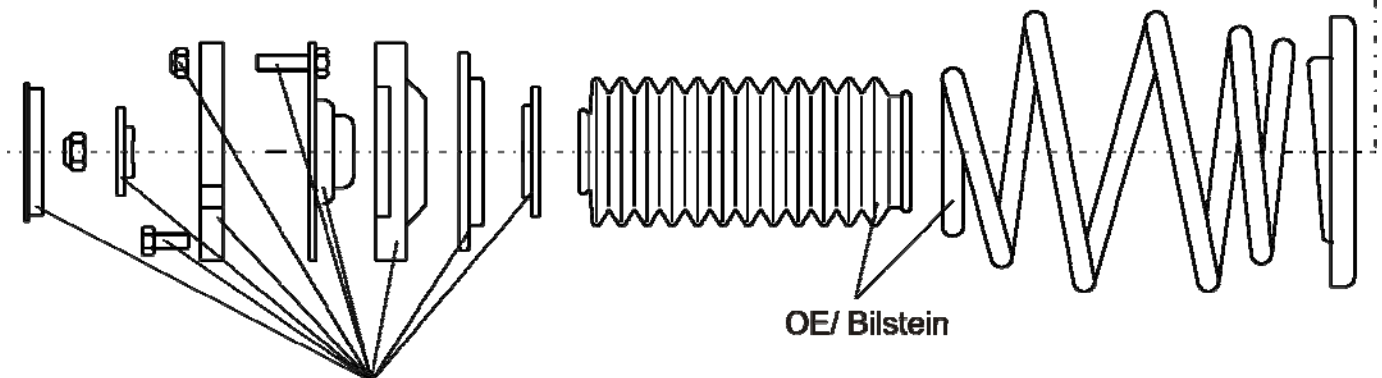
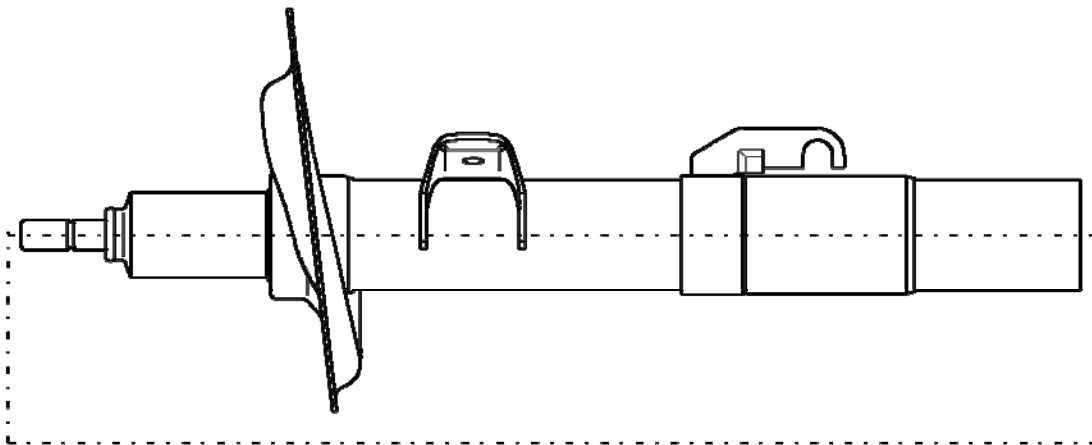

OE = Original Equipment

OE

OE/ Bilstein