

# E4-WM5-Y424A01

## MOUNTING INSTRUCTION



### Before installation please observe the following points:

- Read all information in this manual carefully. All suspension components are fitted and removed acc. to the manufacturer's specifications for installing and removal, if not otherwise required in these instructions.
- Check the product for all components before starting installation!
- Check that dimensions and fastening points are comparable between the original and Bilstein shock absorbers.
- Remove the negative battery pole.
- Directional references (left, right, front, rear) are always with reference to the driving direction.
- The tested vehicles are left- hand drive vehicles. The installed location of the BILSTEIN B6 damptronic cable system is optional. The system components may be located anywhere in the vehicle in accordance with the specifications of manufacturer and BILSTEIN.

### After installation please observe the following points:

- After installing [the suspension system](#), caster and camber must be checked and adjusted according to manufacturer's specifications. Check and reset load- dependent brake compensator and ABS system according to manufacturer's specifications.
- Check and adjust headlight setting.
- If the vehicle has been lowered, freedom of movement (clearance) for all wheel/ tire combinations must be checked.
- All rubber- mounted strut/ damper attachments must not be fully tightened until AFTER the suspension system is loaded (wheels on the ground). Other mounting fasteners (for example brackets) must be securely tightened BEFORE load is placed on the suspension system.
- Connect the negative battery pole.

# E4-WM5-Y424A01 MOUNTING INSTRUCTION



## Removal

Place vehicle on a wheel- free car hoist,  
lift it and remove wheels.



***The lower control arm must be supported by suitable means!***

Remove top and bottom  
mounting from support bearing.

Remove original shock absorber.

## Installation

Fit BILSTEIN mounting parts on BILSTEIN  
shock absorber according to the  
sketch *below*.

**ATTENTION:** Do not reuse the original  
plastic- dustcover cap!

Fit BILSTEIN shock absorber to the vehicle  
in reverse order as removal.

### **Installation of the cable harness for rear axle**

Remove original cable inside the plastic cover  
of the dome.

Expand the cross-section of the hole, pass  
the cable from BILSTEIN shock absorber  
through and attach the new cable together  
with the delivered adapter cable to the  
vehicle's cable harness.

Attach the adapter cable on drivers side  
as well as on passenger's side near the shock  
absorber's plug housing by using cable clips  
(delivered by BILSTEIN).



# E4-WM5-Y424A01 MOUNTING INSTRUCTION

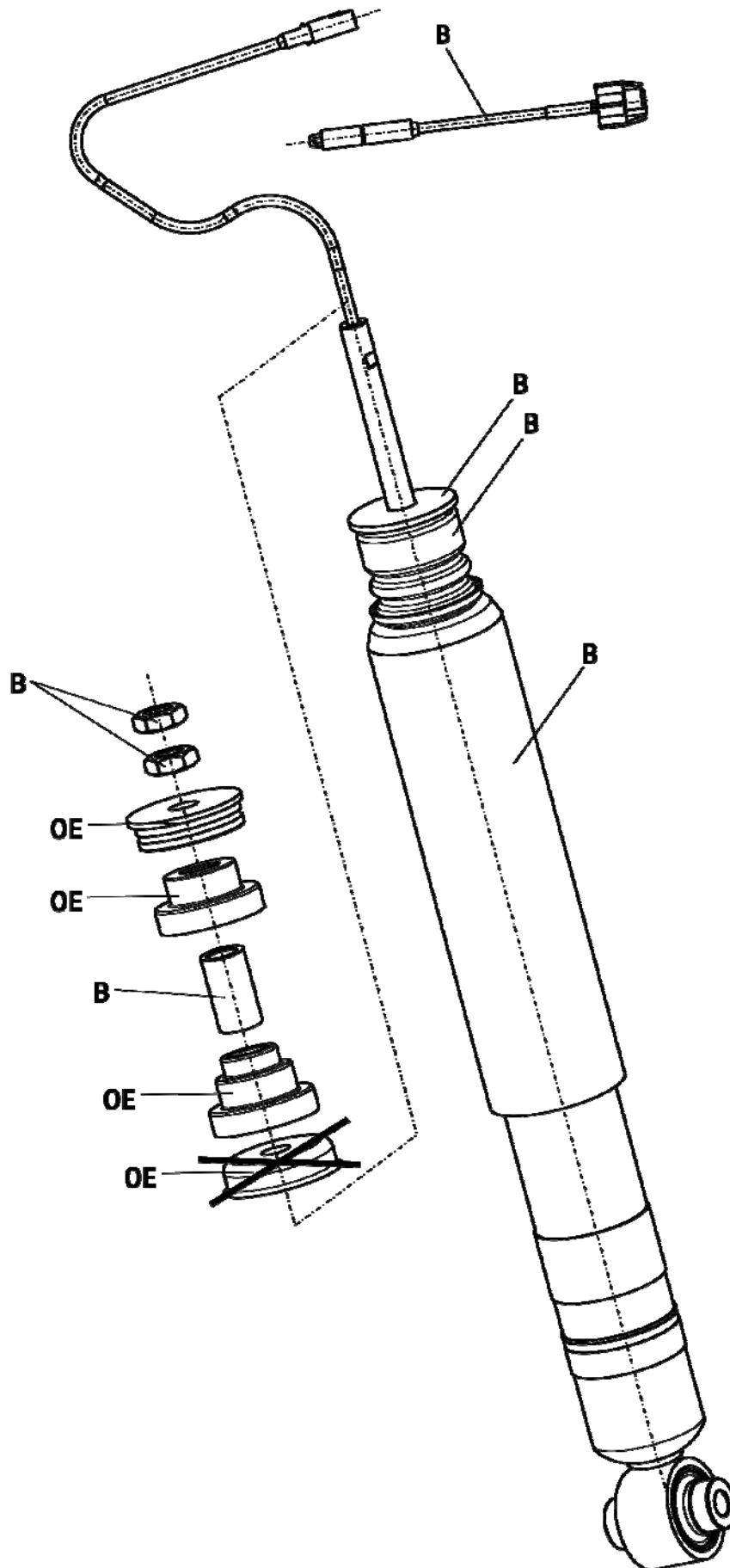

# E4-WM5-Y424A01 MOUNTING INSTRUCTION



All diagrams are generalized  
and not to scale!  
Brackets, etc. specific to  
strut are not shown!

## list of torques

	M 8	M 10	M 12	M 14	M 16
Torque Nm	13	25	45	72	110
Torque ft lb	10	19	34	54	83

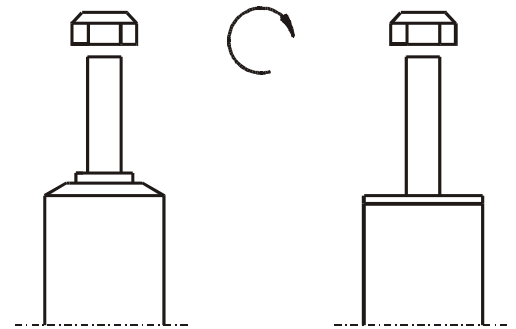

**Do not use an impact tool to loosen  
or tighten fasteners due to possible  
damage to the product.  
Self- locking nuts must only be  
used once!**