

INSTALLATION INSTRUCTIONS.

45-240959 / 45-240966



INSTALLATION INSTRUCTIONS.

BILSTEIN Article No.: 45-240959 / 45-240966

General information:

- Do not store struts below -15°C or above +50°C
- Disassembly and installation may only be performed by fully qualified and certified personnel at a specialist workshop
- Special car manufacturer's tools and equipment are required for replacement work!
- Check air pipes and cables – renew if damaged
- Caution! The vehicle and the air suspension module may be damaged if replacement work is not carried out according to the instructions or in a different order
- BILSTEIN shock absorbers may only be replaced as a set
- Air springs are left and right-hand parts

Dismantling the front strut

- Raise vehicle

Use the chassis lifting points prescribed by the car manufacturer.



Risk of serious bodily injury or death due to the vehicle slipping.

- Vent air from strut with OBD system



The ignition must remain switched off during work on the air suspension module.

- Remove wiper arms and the panel for the cowl
- Remove any parts (control unit etc.) located above the strut in the engine compartment
- Remove wheel
- Remove wheelhouse cover
- Unscrew pressure line on upper end of suspension strut **1**

1



- Secure residual pressure valve when loosening



Do not twist, fold or crimp air line.

- Seal line with plug during work
- Unscrew the nut **2** on the coupling rod of the height sensor and disconnect plug-in connection **3**

2



3

- Disconnect the plug-in connection on the shock absorber **4**

4



- Remove screws at 3 points on strut tower **5** (shown here covered)

5



- Prop up the wheel bearing housing
- Loosen nut **6** on tapered pin on upper suspension arm, but do not unscrew it completely yet.

6



To protect the thread, leave the nut a few turns on the pin.

- Press out the axle guide at the top with the appropriate tool and unscrew nut
- Unscrew coupling rod **7**
- Unscrew spring strut on suspension arm **8**
- Remove strut from below

7



8

Installing the front strut



Fully tighten all movable, suspension-related screw connections only when the vehicle is in ready-to-drive condition, observing the manufacturer's specifications and tightening torques. Caution! Original part may still be pressurised. Loosen residual pressure valve slowly and allow any air to escape.

- Unscrew suspension arm housing with suspension arm **9** from the original part and install on the BILSTEIN spring strut

9



- Insert cable adapter **10** in the parallel damping adjustment unit of the BILSTEIN spring strut, feed around the housing and fasten to the shock absorber's welding stud at the front using the enclosed cable clip **11**

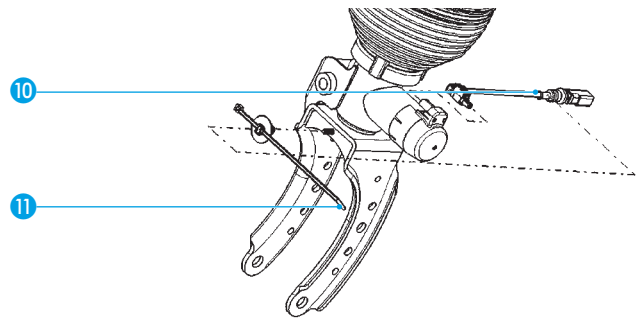

- Fasten the line that leads to the plug to the side of the BILSTEIN spring strut with the other enclosed cable clips
- Replace self-locking nuts
- Reassemble the BILSTEIN strut in reverse order of disassembly
- Detach pressure line connector from BILSTEIN air suspension module; do not remove the plastic plug in advance
- If necessary, replace old pressure line connector with new parts, ensuring correct installation of cone ring (cone pointing towards the line)



Never completely lower the vehicle from the lifting platform with unpressurised air suspension.

- Connect the OBD system and start ignition
- Fill air spring strut using OBD System
- Check air suspension system for leaks
- Lower vehicle from lifting platform
- Fully tighten screw connections loosened during replacement work in accordance with the car manufacturer's specifications
- If necessary, retrain the vehicle's automatic control system

Note: Manufacturer shall not be liable for any injury, loss or damage resulting from any improper alteration, disassembly, handling, installation, service, repair or use of this product, including but not limited to the failure to follow the foregoing instructions. Improper alteration, disassembly, handling, installation, service, repair or use of this product will void the product warranty.